

TA6031FP Through core type precision current transformer **YHDC** 1992[®]

Characteristics:

Epoxy potting, silicon steel core, small size, fully enclosed, electrical load remote monitoring, as the input signal of the electronic control system, phase loss indication, electricity measurement, motor running state monitoring.

Technical index:

- Mounting type: Hanging or plate type
- Material of the core: Silicon steel sheet
- Flame resistance: UL94-V0
- Execution standard: GB20840-2014
- Operating temperature: $-20^{\circ}\text{C} \sim +70^{\circ}\text{C}$
- Storage temperature: $-30^{\circ}\text{C} \sim +80^{\circ}\text{C}$
- Frequency range: 50Hz-60Hz
- Dielectric strength: 6KV 50Hz 1min

Electrical parameters: (The following parameters are typical values and actual values will be subject to product testing)

Model	TA6031FP			Unit
Rated input	400	600	800	A
Rated output	200	200	200	mA
Turns ratio	1: 2000	1: 3000	1: 4000	
Linearity	≤ 0.5	≤ 0.5	≤ 0.5	%
Sampling resistance	10	15	20	Ω
Weight	340	340	340	g

Dimensions (in mm ± 0.5) :

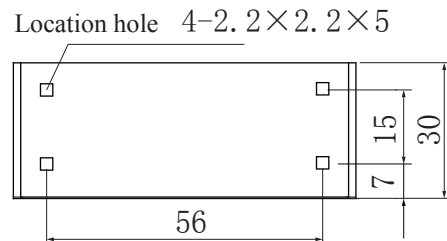
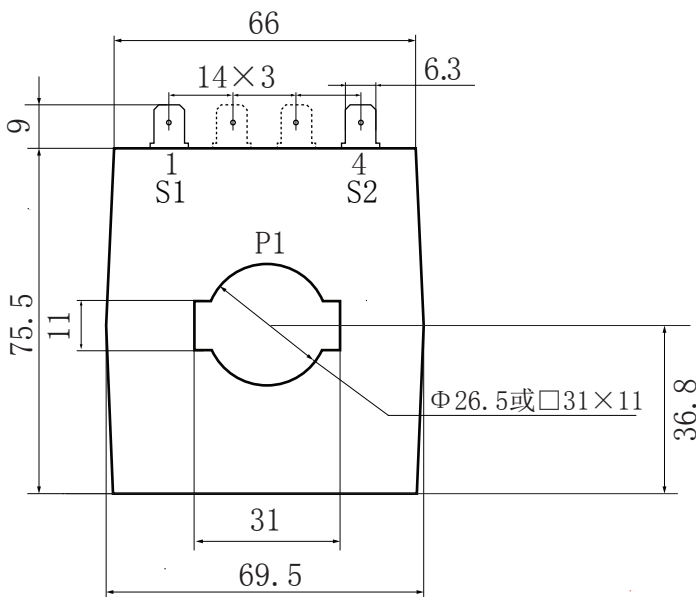

Product picture : (the printed words are for reference only, subject to the actual product)



Schematic diagram:

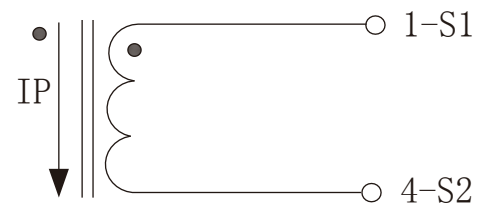

current output type.

the secondary is not allowed to open.