

TEF7628



Patent number: ZL 2020 2 1000365.1

Characteristics:

1. Vacuum epoxy resin encapsulated, 100 °C /6 hours high temperature aging, long working life 20 years and with high delectric strength
2. High quality H18 laminated silicon steel, low temperature, high efficiency
3. PBT engineering plastic, environmental protection, flame retardant, 120 degrees without deformation
4. Reasonable structure, easy installation, low noise, strong earthquake sealed waterproof, moistureproof

Technical index:

Mounting type: Plate

Flame resistance : UL94-V0

Insulation class: B

Operation temperature: -30 °C ~ +40 °C

Work frequency: 50Hz~60Hz

Dielectric strength: Pri/Sec 3.75KV 50Hz 1min 5mA

Electrical parameters: The following parameters are typical values. The actual values shall be subject to the actual measurement of the product

Primary voltage	110V	220V	230V	380V	Unit
Primary voltage range	± 10				%
Power	80				VA
Voltage regulation	≤ 12				%
Temperature rising	≤ 40				°C
No-load loss	≤ 3				W
Weight	1400				g

Dimensions (in mm±0.5)

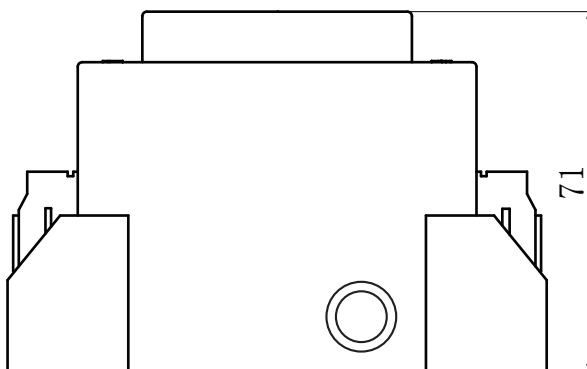

Front view

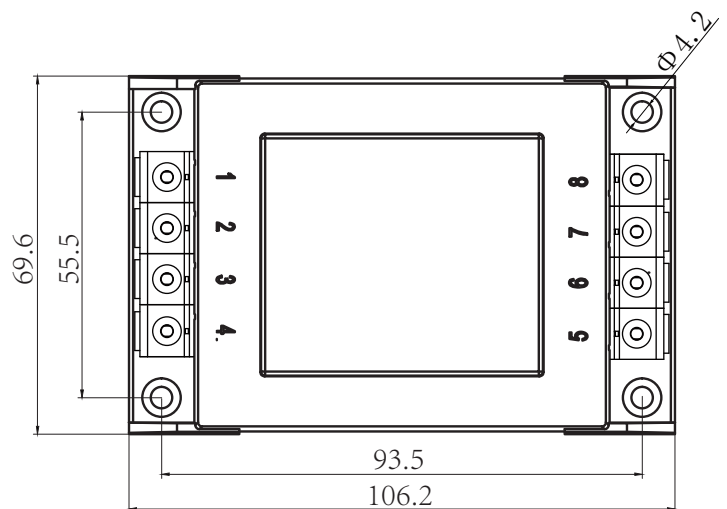

Top view

Product picture print for reference only, subject to the actual product



Standard output parameter table:

(Factory test is based on the full-load vottage)

Secondary full-load voltage	Secondary no-load voltage	Secondary full-load current	Fuse
6V	6.6V	13.3A	15A (250V)
7.5V	8.25V	10.7A	12A (250V)
9V	9.9V	8.89A	10A (250V)
12V	13.2V	6.66A	7A (250V)
15V	16.5V	5.33A	6A (250V)
18V	19.8V	4.44A	5A (250V)
24V	26.4V	3.33A	4A (250V)

Schematic diagram:

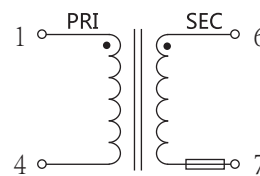

Optional types of fuse

0.1A (250V)	0.2A (250V)	0.5A (250V)
1A (250V)	1.5A (250V)	2A (250V)
3A (250V)	3.15A (250V)	4A (250V)
5A (250V)	6A (250V)	6.3A (250V)
7A (250V)	8A (250V)	10A (250V)
12A (250V)	15A (250V)	