

3-SCT013-RJ12



Characteristics:

Three-phase integrated split core current transformer, easy installation, RJ12 connector output.

Technical index:

Mounting type: Free hanging (In-Line)

Material of core: Ferrite

Applicable standards: GB20840-2014

Operating temperature: $-25^{\circ}\text{C} \sim +60^{\circ}\text{C}$

Storage temperature: $-30^{\circ}\text{C} \sim +90^{\circ}\text{C}$

Frequency range: 50Hz-1KHz

Dielectric strength: Input (bare conductor)/Output AC 800V/1min 50Hz
Output/Housing AC 3.5KV/1min 50Hz

Product picture printing is for reference only, subject to the actual product



Electrical parameters: The following parameters are typical values. The actual values shall be subject to the actual measurement of the product

Rated input	50	100	A	<p>TVS: Transient Voltage Suppressor (7.5V) Current output type The secondary is not allowed to open circuit</p>
Rated output	50	50	mA	
Turns ratio	1 : 1000	1 : 2000	-	
Accuracy	1	1/0.5	%	
Sampling resistance	10		Ω	
Weight	150		g	

Dimensions (unit mm \pm 0.5) :

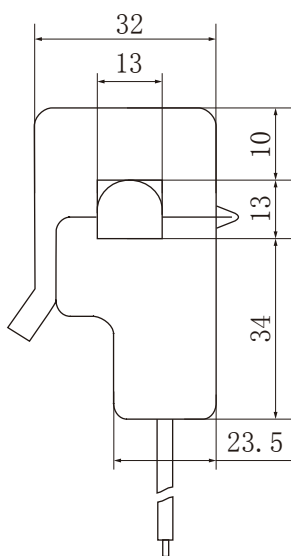

Front view

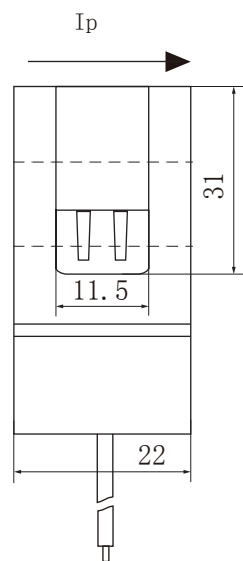

Side view

